

LOTS 53R AND 55R, SHOCK HILL SUBDIVISION

A RESUBDIVISION OF LOT 53 AND LOT 54, SHOCK HILL SUBDIVISION
SECTION 36, TOWNSHIP 6 SOUTH, RANGE 78 WEST OF THE SIXTH PRINCIPAL MERIDIAN
TOWN OF BRECKENRIDGE, COUNTY OF SUMMIT, STATE OF COLORADO

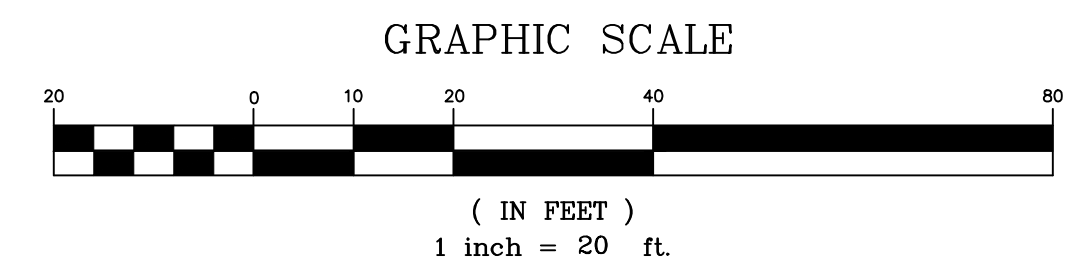

TITLE COMPANY CERTIFICATE

XXXXXXXXXX Guarantee Company, does hereby certify that it has examined the title to all lands shown hereon and all lands shown hereon and all lands herein dedicated by virtue of this plat and title to all such lands is in the dedicator free and clear of all liens, taxes and encumbrances, except as follows:

Dated this _____ day of _____, 2015.

XXXXX GUARANTEE COMPANY

BY: _____

TOWN OF BRECKENRIDGE CERTIFICATE

This plat is approved this _____ day of _____, 2015.

TOWN OF BRECKENRIDGE

By: _____
 Director, Department of Community Development

Notice:

Public notice is hereby given that the Town of Breckenridge hereby accepts all of the offers of dedication made by this plat. However, such acceptance does not constitute an acceptance of the roads and rights of way reflected hereon for maintenance by the Town.

Until such roads and rights of way meet Town road specifications and are specifically accepted by the Town, the maintenance, construction, and all other matters pertaining to or affecting said roads and rights of way are the sole responsibility of the owners of the land embraced within this subdivision.

NOTE: The Town Certificate on any subdivision plat may be executed by the Director of the Department of Community Development, or any Assistant Director.

CERTIFICATE OF TAXES PAID

I, the undersigned, do hereby certify that the entire amount of all taxes due and payable as of _____, 2015 upon parcels of real estate described on this plat are paid in full.

Dated this _____ day of _____, 2015.

 Summit County Treasurer or Designee

TOWN CLERK'S CERTIFICATE

STATE OF COLORADO)
 COUNTY OF SUMMIT)
 TOWN OF BRECKENRIDGE)

I hereby certify that this instrument was filed in my office at _____ O'clock, __ M. this _____ day of _____, 2015, and is duly recorded.

 Town Clerk

CLERK AND RECORDER'S CERTIFICATE

STATE OF COLORADO)
 COUNTY OF SUMMIT)

I hereby certify that this instrument was filed in my office at _____ O'clock, __ M. this _____ day of _____, 2015, and filed under Reception Number _____

 Summit County Clerk and Recorder

LEGEND

- ⊗ SET REBAR & PINK CAP (PLS No. 37047)
- FOUND REBAR & ALUM. CAP (PLS No. 25620)

SCHMIDT
 LAND SURVEYING, INC
 P.O. Box 5761
 FRISCO, CO 80443 970-409-9963

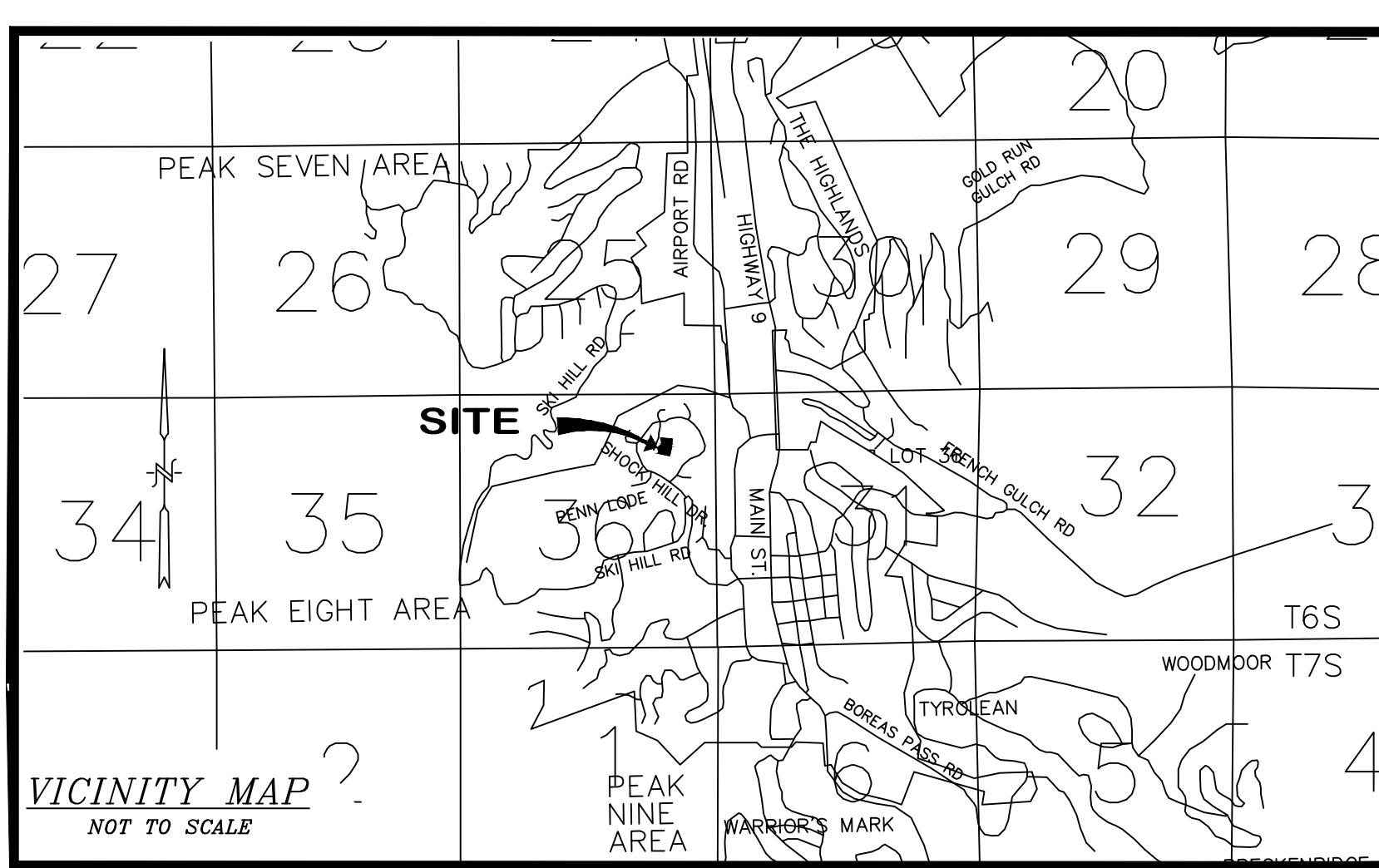

VICINITY MAP?
 NOT TO SCALE

OWNER'S CERTIFICATE

Know all men by these presents: that XXXXXXXXX, being owner in fee simple of the real property, more particularly described as follows:

Lot 53 Shock Hill Subdivision, according to the plat recorded November 6, 2002 at Reception No. 701141, in the Office of the Clerk and Recorder, Summit County, Colorado.

Lots 54 and 55 Shock Hill Subdivision, according to the plat recorded November 6, 2002 at Reception No. 701142, in the Office of the Clerk and Recorder, Summit County, Colorado.

Containing 1.55 acres, more or less, has laid out, as shown hereon under the name and style of lot 53R and Lot 55R Shock Hill Subdivision.

IN WITNESS WHEREOF, The said owners, have caused their names to be hereunto subscribed this _____ day of _____, 2015.

 XXXXXXXXXXXXXXXXXX

 XXXXXXXXXXXXXXXXXX

STATE OF COLORADO)
 COUNTY OF SUMMIT)

The foregoing instrument was acknowledged before me this _____ day of _____, 2015.

By: XXXXXXXXXX

Witness my hand and official seal.

MY COMMISSION EXPIRES: _____

 Notary Public

STATE OF COLORADO)
 COUNTY OF SUMMIT)

The foregoing instrument was acknowledged before me this _____ day of _____, 2015.

By: XXXXXXXXXX

Witness my hand and official seal.

MY COMMISSION EXPIRES: _____

 Notary Public

STATE OF COLORADO)
 COUNTY OF SUMMIT)

The foregoing instrument was acknowledged before me this _____ day of _____, 2015.

By: XXXXXXXXXX

Witness my hand and official seal.

MY COMMISSION EXPIRES: _____

 Notary Public

PLAT NOTES

1. Date of Survey: September, 2015.
2. Basis of Bearing: The Easterly Property line of Lots 53 and 54 (1.5" Aluminum Caps, PLS 25620) being N 09°40'25" W.
3. NOTICE: According to Colorado law you must commence any legal action based upon any defect in this survey within three years after you first discover such defect. In no event may any action based upon any defect in this survey be commenced more than ten years from the date of the certification shown hereon.
4. The property described in the Owner's Certificate and depicted on this Plat is subject to the easements, terms, conditions and provisions provided for on the plat of Shock Hill Subdivision recorded November 6, 2002, at Reception No. 701141 and the plat of Shock Hill Subdivision recorded November 6, 2002 at Reception No. 701442
- 5.

SURVEYOR'S CERTIFICATE

I, Elizabeth K. Schmidt, a Colorado Registered Land Surveyor, do hereby certify that this Plat of Tract C, Shock Hill Subdivision was prepared by me and under my supervision, and that both this Plat and the survey are true and accurate to the best of my knowledge and belief and that the monuments were placed pursuant to C.R.S. 38-51-105 and do hereby further certify that all information required by C.R.S. 38-33.3-209 is contained on this Plat.

Dated this _____ day of _____, 2015.

Elizabeth K. Schmidt, PLS NO. 37047

